

I-TL Internal parts of non return valve

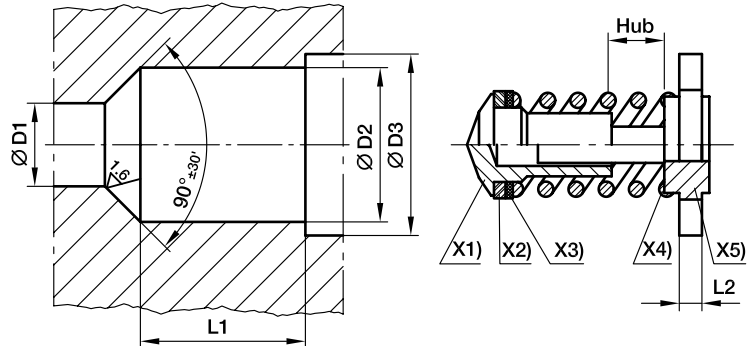

- X1) poppet
- X2) sealing disc (smooth side to the poppet)
- X3) cover disc
- X4) spring
- X5) passage disc

| Series | Tube O.D. | D1 ^{+0.1} | D2 ^{+0.1} | D3 ^{+0.1} | L1 ^{±0.1} | L2 | Hub | Weight g/1 piece | Order code* | PN (bar) ¹⁾ | |
|--------|-----------|--------------------|--------------------|--------------------|--------------------|-----|-----|------------------|----------------|------------------------|----|
| | | | | | | | | | | A3C | 71 |
| L/S/S | 06/06/08 | 3.5 | 7.5 | 8.6 | 8.2 | 2.0 | 1.0 | 2 | ITL06L/06+08S | * | * |
| L/S | 08/10 | 5.5 | 10.2 | 11.6 | 11.0 | 2.0 | 1.7 | 4 | ITL08L/10S | * | * |
| L/S | 10/12 | 7.5 | 13.0 | 14.1 | 14.0 | 2.0 | 2.3 | 7 | ITL10L/12S | * | * |
| L/S | 12/14 | 9.5 | 16.7 | 18.1 | 16.5 | 2.5 | 2.9 | 13 | ITL12L/14S | * | * |
| L/S | 15/16 | 11.5 | 19.5 | 20.6 | 19.0 | 2.5 | 3.5 | 18 | ITL15L/16S | * | * |
| L/S | 18/20 | 15.0 | 25.2 | 27.1 | 22.5 | 3.0 | 4.4 | 37 | ITL18L/20S | * | * |
| L/S | 22/25 | 19.0 | 30.8 | 32.6 | 27.0 | 3.0 | 5.5 | 54 | ITL22L/25S | * | * |
| L/S | 28/30 | 24.0 | 38.6 | 40.6 | 32.5 | 3.5 | 7.3 | 107 | ITL28L/30S | * | * |
| L/L/S | 35/38/42 | 29.0 | 45.7 | 48.1 | 37.5 | 3.5 | 8.9 | 144 | ITL35L+42I/38S | * | * |

* = item deliverable

Delivery without nut and ring. Information on ordering complete fittings or alternative sealing materials see page 17.

*Please add the **suffixes** below according to the material/ surface required.

| Order code suffixes | | | |
|---------------------------|-----------------------------|------------------|---|
| Material | Suffix surface and material | Example | Standard sealing material (no additional suffix needed) |
| Steel, zinc yellow plated | A3C | ITL06L/06+008S | NBR |
| Stainless steel | 71 | ITL06L71/06+008S | VIT |