

# Mini Series



Equipped with push-in connections and a technical polymer body, this series combines lightness on the equipment, speed of installation.

## Technical Characteristics

- **Compatible Fluids:** Compressed air, neutral gases
- **Working Pressure:** Vacuum to 10 bar
- **Working Temperature:** -20°C to +80°C

Tightening Torques	Threads	G1/8	G1/4	G3/8	G1/2
	daN.m	0.8	1.2	3	3.5

Reliable performance is dependent upon the type of fluid conveyed, component materials and tubing being used.

Guaranteed for use with a vacuum of 755 mm Hg (99 % vacuum).

## Advantages

- Lightweight and compact
- LF 3000® push-in connections, static and dynamic sealing
- Automatic seal wear compensation for long-term reliability
- Ultra-compact handle, easy operation, screwdriver slot for difficult access

## Component Materials

### Silicone-free

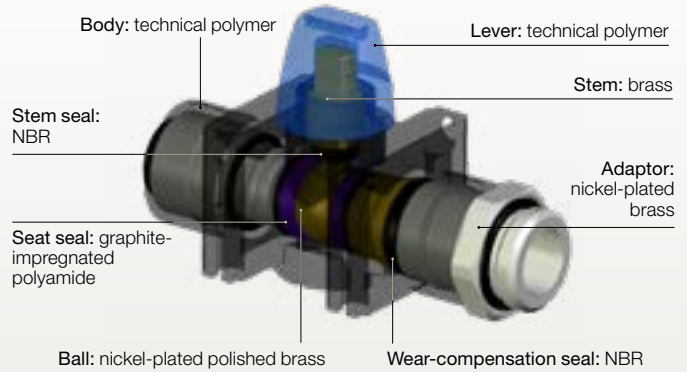

## Installation Options

### Vented Valve, Open Position

3/2 model with vent

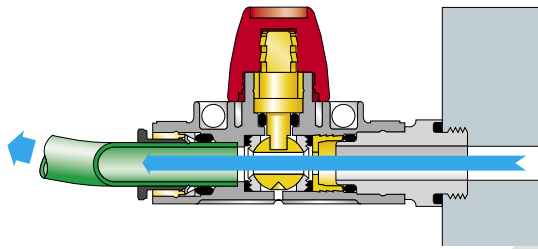

### Vented Valve, Closed Position

Lever with screwdriver slot

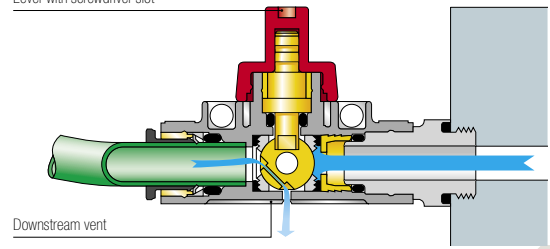

## 7910 2/2 In-Line Mini-Ball Valve

Technical polymer, NBR

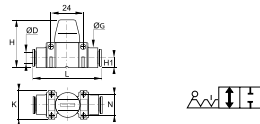

ØD		G	H	H1	K	L	N	Kg
4	7910 04 00	15	37	7.5	22	51	16	0.039
6	7910 06 00	15	37	7.5	22	52	16	0.034
8	7910 08 00	15	37	7.5	22	52	16	0.025
10	7910 10 00	20	43	11	30	66	22	0.060
12	7910 12 00	20	43	11	30	66	22	0.040

## 7911 2/2 In-Line Mini-Ball Valve, Male BSPP Thread

Technical polymer, Nickel-plated brass, NBR

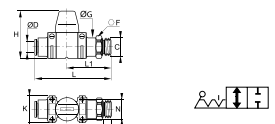

ØD	C		E	F	G	H	K	L	L1	N	Kg
6	G1/8	7911 06 10	5	13	14	37	22	62	37	16	0.045
8	G1/4	7911 08 13	5.5	16	17.5	37	22	61	35	16	0.040
10	G3/8	7911 10 17	5.5	20	22	43	30	74	41	22	0.075
12	G1/2	7911 12 21	7.5	24	26	43	30	75	42	22	0.075

## 7913 3/2 In-Line Mini-Ball Valve with Vent

Technical polymer, NBR

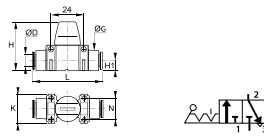

ØD		G	H	H1	K	L	N	Kg
4	7913 04 00	15	37	7.5	22	51	16	0.040
6	7913 06 00	15	37	7.5	22	52	16	0.035
8	7913 08 00	15	37	7.5	22	52	16	0.025
10	7913 10 00	20	43	11	30	66	22	0.060
12	7913 12 00	20	43	11	30	66	22	0.045

## 7914 3/2 In-Line Mini-Ball Valve with Vent, Male BSPP Thread

Technical polymer, Nickel-plated brass, NBR

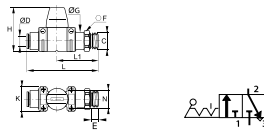

ØD	C		E	F	G	H	K	L	L1	N	Kg
6	G1/8	7914 06 10	5	13	14	37	22	62	37	16	0.045
8	G1/4	7914 08 13	5.5	16	17.5	37	22	61	35	16	0.040
10	G3/8	7914 10 17	5.5	20	22	43	30	74	41	22	0.058
12	G1/2	7914 12 21	7.5	24	26	43	30	75	42	22	0.075

## 7000 Joining Clips

Technical polymer



ØD		Kg
4	7000 00 04	0.001
6-8	7000 00 05	0.005
10-12	7000 00 06	0.001

## Complementary Products for Mini Series

LF 3000®

PA Tubing

PU Tubing

Flow Regulators

